

## FEATURES

- 2800-6500K continuous CCT tuning
- 1000W tungsten output (320W draw)
- High CRI values at every color temperature
- $\pm 0.25$  green adjustment
- Dims to 0% without flicker or color shift
- Precise color calibration for consistent quality
- LCD display for monitoring settings
- DMX controllable (3-channels: intensity, CCT, hue)
- XLR-3 power port for easy connection to 48V batteries
- Ruggedized frame
- Water resistant (IP-24)

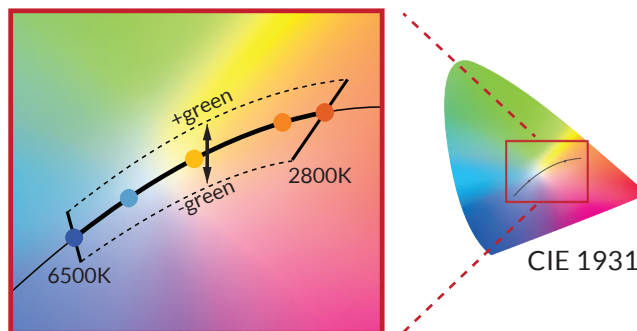

**4D COLOR MAPPING** ensures cinema-caliber precision and light quality at all settings



**MULTI-PHOSPHOR SPECTRUM** for excellent color rendering

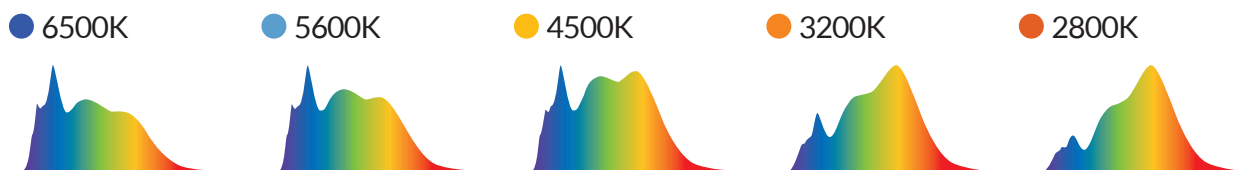

Industry-leading CRI scores on difficult color samples (R9, R12)

CCT	R1	R2	R3	R4	R5	R6	R7	R8	R9	R10	R11	R12	R13	R14	R15	CRI <sub>Ra</sub> *	CRI <sub>Ext</sub> *	TLCI
3200K	98	99	94	98	98	97	98	97	96	95	97	89	98	95	97	97	96	98
5600K	98	98	97	96	97	96	98	97	94	95	96	87	99	98	98	97	96	98
6500K	98	98	98	96	97	96	97	97	95	96	96	87	98	99	97	97	96	98

\*CRI<sub>Ra</sub> is the averaged result of R1 to R8; CRI<sub>Ext</sub> is the averaged value of R1 to R15. Typical values shown.

## PHOTOMETRIC DATA

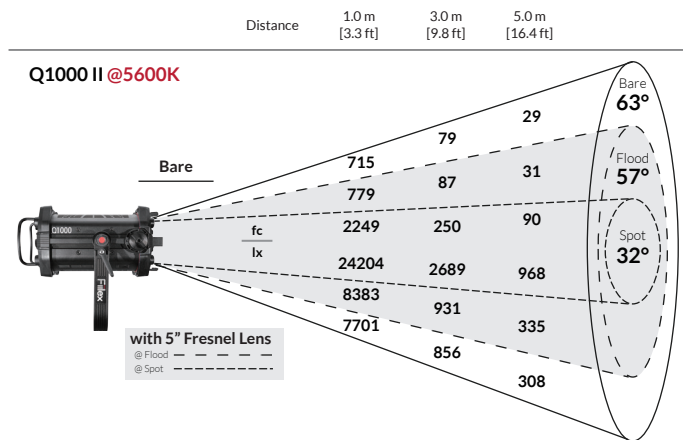
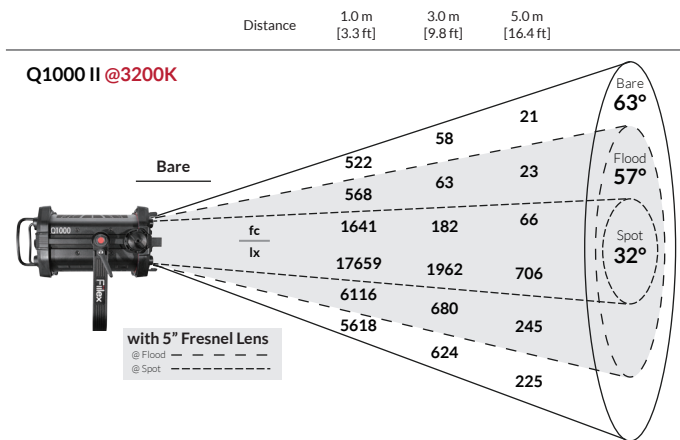

## SPECIFICATIONS

Beam Angle	63° (57° - 32° With 5" Fresnel Lens)
CCT Range	2800 - 6500K Continuous Tuning
CRI	97 Typical
Hue	±0.25 Green
Dimming	100% - 0% Flicker Free
Light Engine	Dense Matrix LED
Power Draw	320W Max
DC Input	48V DC (300W DC Max)
AC Input	100 - 240V AC, 50 ~ 60Hz
Power Port	XLR-3P
DMX Control	3-CH (Intensity, CCT, Hue) via 2x XLR-5P and 2x RJ45 Ports
Weight	15.2lbs / 6.9kg (Includes Yoke)   Power Adapter 6lbs / 2.7kg
Size (L x W x H)	14.2in x 12.3in x 15.7in / 36.1cm x 31.2cm x 39.9cm
Mount	Baby Stud 5/8" Female (16mm) & Junior Stud 1-1/8" Male (28mm)
IP Rating	IP-24 (Dust & Water Resistant)
Thermal Design	Advanced Vapor Cooling System (Fan Cooled)
Operating Temperature	32 - 104°F / 0 - 40° C

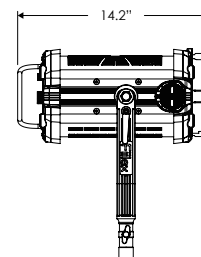
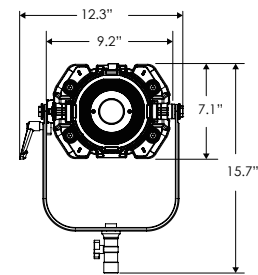

## OPTIONAL ACCESSORIES & KITS



**Dome Diffuser**  
FLXA006



**Dome Diffuser Extension**  
FLXA007



**Para Softbox & Speedring**  
FLXA040



**PAR Reflector**  
FLXA037



**X311 Gaffer's Kit**  
2 x P360 Pro Plus  
FLXX311

